

LINER TRANSFORMER

FWLT EI30 SERIES

- Power – 0.6VA to 2.8VA
- Dielectric strength – 2500Vrms
- High ambient operation temperature (+70°C maximum)
- Primary (115V 60Hz)
- Secondary – Single or Dual
- Insulation class – Class B (130°C)

PHYSICAL CHARACTERISTICS

TECHNICAL INFORMATION

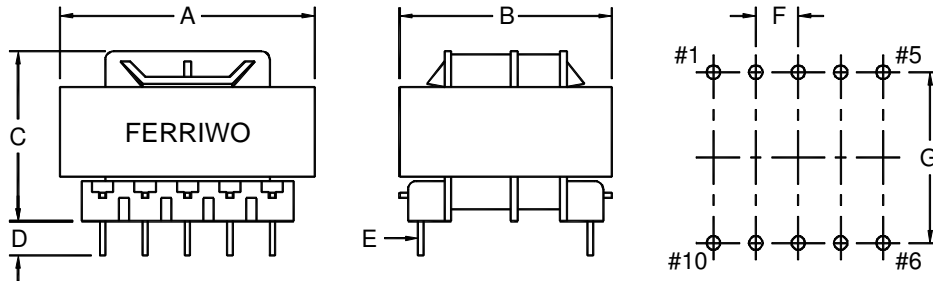

Note: Unused pins are omitted for standard parts. Unused pins can be provided upon request.

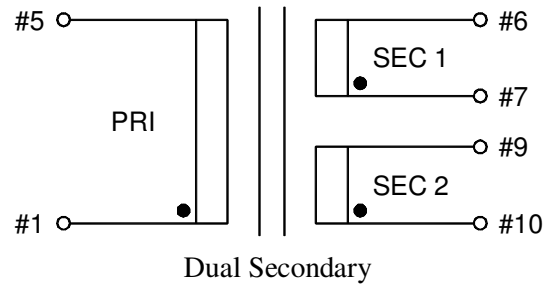
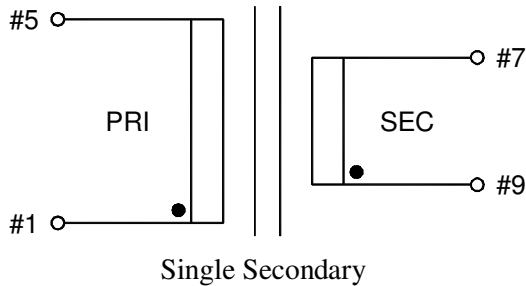

PRODUCT SERIES	DIMENSION (MM)							WEIGHT (g)
	A	B	C	D	E	F	G	
0.6VA	31.0	26.0	15.0	4.0	SQ 0.64	5.0	20.0	35
1.0VA	31.0	26.0	22.5	4.0	SQ 0.64	5.0	20.0	70
1.2VA	31.0	26.0	22.5	4.0	SQ 0.64	5.0	20.0	70
1.5VA	31.0	26.0	22.5	4.0	SQ 0.64	5.0	20.0	70
1.8VA	31.0	26.0	27.5	4.0	SQ 0.64	5.0	20.0	85
2.1VA	31.0	26.0	27.5	4.0	SQ 0.64	5.0	20.0	85
2.3VA	31.0	26.0	29.5	4.0	SQ 0.64	5.0	20.0	95
2.4VA	31.0	26.0	27.5	4.0	SQ 0.64	5.0	20.0	85
2.7VA	31.0	26.0	29.5	4.0	SQ 0.64	5.0	20.0	95
2.8VA	31.0	26.0	29.5	4.0	SQ 0.64	5.0	20.0	95
Tolerance	max.	max.	max.	±0.1	±0.1	±0.2	±0.5	approx.

FWLT EI30 SERIES

Product Series	Primary(V)	Single Secondary			Dual Secondary		
		Part Number	Secondary Rating		Part Number	Secondary Rating	
			(V)	(mA)		(V)	(mA)
0.6 VA	115	FWLTEI30S-1001	6	100	FWLTEI30D-1001	2x6	50
		FWLTEI30S-1002	7.2	83	FWLTEI30D-1002	2x7.2	42
		FWLTEI30S-1003	9	67	FWLTEI30D-1003	2x9	33
		FWLTEI30S-1004	10	60	FWLTEI30D-1004	2x10	30
		FWLTEI30S-1005	12	50	FWLTEI30D-1005	2x12	25
		FWLTEI30S-1006	15	40	FWLTEI30D-1006	2x15	20
		FWLTEI30S-1007	18	33	FWLTEI30D-1007	2x18	17
		FWLTEI30S-1008	24	25	FWLTEI30D-1008	2x24	12
1.0 VA	115	FWLTEI30S-1009	6	167	FWLTEI30D-1009	2x6	83
		FWLTEI30S-1010	7.2	139	FWLTEI30D-1010	2x7.2	69
		FWLTEI30S-1011	9	111	FWLTEI30D-1011	2x9	56
		FWLTEI30S-1012	10	100	FWLTEI30D-1012	2x10	50
		FWLTEI30S-1013	12	83	FWLTEI30D-1013	2x12	42
		FWLTEI30S-1014	15	67	FWLTEI30D-1014	2x15	33
		FWLTEI30S-1015	18	56	FWLTEI30D-1015	2x18	28
		FWLTEI30S-1016	24	42	FWLTEI30D-1016	2x24	21
1.2 VA	115	FWLTEI30S-1017	6	200	FWLTEI30D-1017	2x6	100
		FWLTEI30S-1018	7.2	167	FWLTEI30D-1018	2x7.2	83
		FWLTEI30S-1019	9	133	FWLTEI30D-1019	2x9	67
		FWLTEI30S-1020	10	120	FWLTEI30D-1020	2x10	60
		FWLTEI30S-1021	12	100	FWLTEI30D-1021	2x12	50
		FWLTEI30S-1022	15	80	FWLTEI30D-1022	2x15	40
		FWLTEI30S-1023	18	67	FWLTEI30D-1023	2x18	33
		FWLTEI30S-1024	24	50	FWLTEI30D-1024	2x24	25
1.5 VA	115	FWLTEI30S-1025	6	250	FWLTEI30D-1025	2x6	125
		FWLTEI30S-1026	7.2	208	FWLTEI30D-1026	2x7.2	104
		FWLTEI30S-1027	9	167	FWLTEI30D-1027	2x9	83
		FWLTEI30S-1028	10	150	FWLTEI30D-1028	2x10	75
		FWLTEI30S-1029	12	125	FWLTEI30D-1029	2x12	62
		FWLTEI30S-1030	15	100	FWLTEI30D-1030	2x15	50
		FWLTEI30S-1031	18	83	FWLTEI30D-1031	2x18	42
		FWLTEI30S-1032	24	62	FWLTEI30D-1032	2x24	31
1.8 VA	115	FWLTEI30S-1033	6	300	FWLTEI30D-1033	2x6	150
		FWLTEI30S-1034	7.2	250	FWLTEI30D-1034	2x7.2	125
		FWLTEI30S-1035	9	200	FWLTEI30D-1035	2x9	100
		FWLTEI30S-1036	10	180	FWLTEI30D-1036	2x10	90
		FWLTEI30S-1037	12	150	FWLTEI30D-1037	2x12	75
		FWLTEI30S-1038	15	120	FWLTEI30D-1038	2x15	60
		FWLTEI30S-1039	18	100	FWLTEI30D-1039	2x18	50
		FWLTEI30S-1040	24	76	FWLTEI30D-1040	2x24	38

FWLT EI30 SERIES

Product Series	Primary(V)	Single Secondary			Dual Secondary		
		Part Number	Secondary Rating		Part Number	Secondary Rating	
			(V)	(mA)		(V)	(mA)
2.1 VA	115	FWLTEI30S-1041	6	350	FWLTEI30D-1041	2x6	175
		FWLTEI30S-1042	7.2	292	FWLTEI30D-1042	2x7.2	146
		FWLTEI30S-1043	9	234	FWLTEI30D-1043	2x9	117
		FWLTEI30S-1044	10	210	FWLTEI30D-1044	2x10	105
		FWLTEI30S-1045	12	176	FWLTEI30D-1045	2x12	88
		FWLTEI30S-1046	15	140	FWLTEI30D-1046	2x15	70
		FWLTEI30S-1047	18	118	FWLTEI30D-1047	2x18	59
		FWLTEI30S-1048	24	88	FWLTEI30D-1048	2x24	44
2.3 VA	115	FWLTEI30S-1049	6	383	FWLTEI30D-1049	2x6	191
		FWLTEI30S-1050	7.2	319	FWLTEI30D-1050	2x7.2	159
		FWLTEI30S-1051	9	255	FWLTEI30D-1051	2x9	127
		FWLTEI30S-1052	10	230	FWLTEI30D-1052	2x10	115
		FWLTEI30S-1053	12	191	FWLTEI30D-1053	2x12	95
		FWLTEI30S-1054	15	153	FWLTEI30D-1054	2x15	76
		FWLTEI30S-1055	18	127	FWLTEI30D-1055	2x18	63
		FWLTEI30S-1056	24	96	FWLTEI30D-1056	2x24	48
2.4 VA	115	FWLTEI30S-1057	6	400	FWLTEI30D-1057	2x6	200
		FWLTEI30S-1058	7.2	334	FWLTEI30D-1058	2x7.2	167
		FWLTEI30S-1059	9	268	FWLTEI30D-1059	2x9	134
		FWLTEI30S-1060	10	240	FWLTEI30D-1060	2x10	120
		FWLTEI30S-1061	12	200	FWLTEI30D-1061	2x12	100
		FWLTEI30S-1062	15	160	FWLTEI30D-1062	2x15	80
		FWLTEI30S-1063	18	134	FWLTEI30D-1063	2x18	67
		FWLTEI30S-1064	24	100	FWLTEI30D-1064	2x24	50
2.7 VA	115	FWLTEI30S-1065	6	450	FWLTEI30D-1065	2x6	225
		FWLTEI30S-1066	7.2	375	FWLTEI30D-1066	2x7.2	187
		FWLTEI30S-1067	9	300	FWLTEI30D-1067	2x9	150
		FWLTEI30S-1068	10	270	FWLTEI30D-1068	2x10	135
		FWLTEI30S-1069	12	225	FWLTEI30D-1069	2x12	112
		FWLTEI30S-1070	15	180	FWLTEI30D-1070	2x15	90
		FWLTEI30S-1071	18	150	FWLTEI30D-1071	2x18	75
		FWLTEI30S-1072	24	112	FWLTEI30D-1072	2x24	56
2.8 VA	115	FWLTEI30S-1073	6	466	FWLTEI30D-1073	2x6	233
		FWLTEI30S-1074	7.2	388	FWLTEI30D-1074	2x7.2	194
		FWLTEI30S-1075	9	311	FWLTEI30D-1075	2x9	155
		FWLTEI30S-1076	10	280	FWLTEI30D-1076	2x10	140
		FWLTEI30S-1077	12	233	FWLTEI30D-1077	2x12	116
		FWLTEI30S-1078	15	186	FWLTEI30D-1078	2x15	93
		FWLTEI30S-1079	18	155	FWLTEI30D-1079	2x18	77
		FWLTEI30S-1080	24	116	FWLTEI30D-1080	2x24	58